

# Surface Mount Reel Specifications

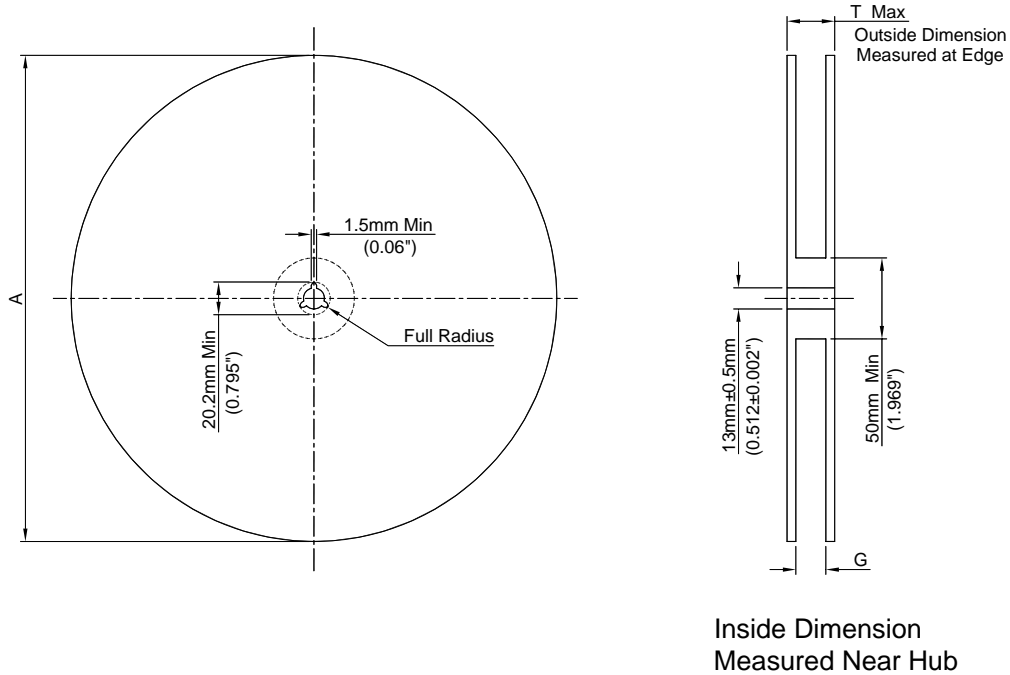

Size	A (Max.)	G	T (Max.)	Type of case	Qty / reel
8 mm	330 mm ( 12.992" )	8.4 mm + 1.5 mm, -0.0 ( 0.33" + 0.059", -0.00)	14.4 mm ( 0.56" )	LS-31 Others	12,000 10,000
12 mm	330 mm ( 12.992" )	12.4 mm + 2 mm, -0.0 ( 0.49" + 0.079", -0.00)	18.4 mm ( 0.72" )	LL-41	5,000

## Reel Dimensions

Metric Dimensions Govern - English are in parentheses for reference only

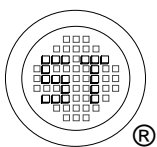

**SEMTECH ELECTRONICS LTD.**  
Subsidiary of Sino-Tech International (BVI) Limited

