

Embossed Tape and Reel Data for Surface Mount Transistors

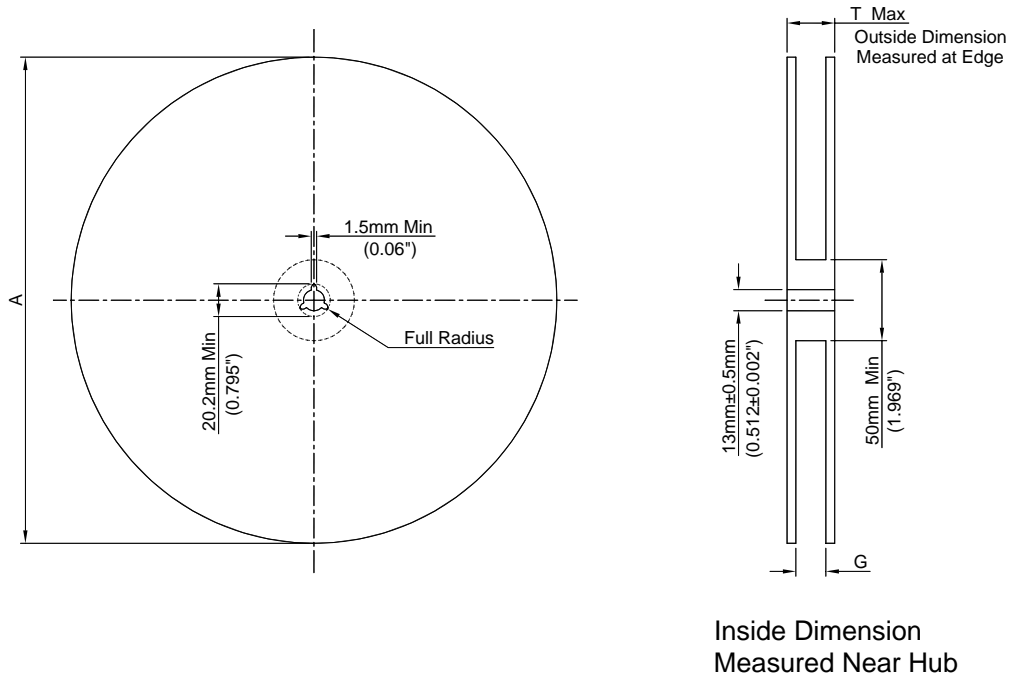

Size	A (Max.)	G	T (Max.)
8 mm	330 mm (12.992")	8.4 mm + 1.5 mm, -0.0 (0.33" + 0.059", -0.00)	14.4 mm (0.56")
12 mm	330 mm (12.992")	12.4 mm + 2.0 mm, -0.0 (0.49" + 0.079", -0.00)	18.4 mm (0.72")
16 mm	360 mm (14.173")	16.4 mm + 2.0 mm, -0.0 (0.646" + 0.078", -0.00)	22.4 mm (0.882")
24 mm	360 mm (14.173")	24.4 mm + 2.0 mm, -0.0 (0.961" + 0.070", -0.00)	30.4 mm (1.197")

Reel Dimensions

Metric Dimensions Govern - English are in parentheses for reference only

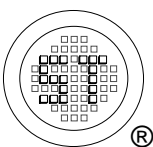

SEMTECH ELECTRONICS LTD.
Subsidiary of Sino-Tech International (BVI) Limited



Dated : 23/04/2008